

< rýchl. cesta R1
< SERED
< ŠOPORŇA

CESTA II/573
kateg. C7,5/70

VB 4 | I/573
R 18000


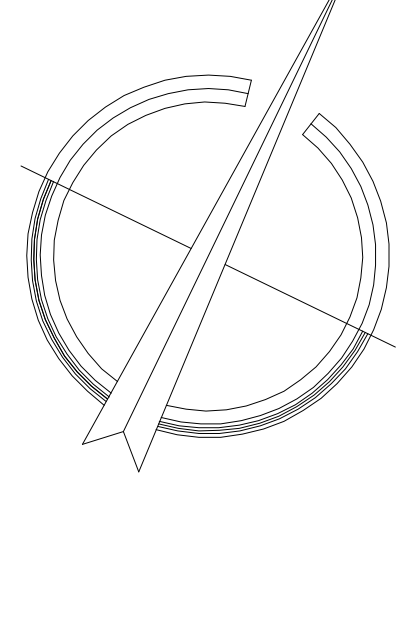

4.7 4.8 4.9 5.0 5.1 5.2 5.3 5.4 5.5 5.6 5.7 5.8 5.9 6.0 6.1

4.841 4.873

USEK VYSTAVBY MOSTA
SAMOSTATNÁ STAVBA

ZAČIATOK REKONŠTRUKCIE CESTY II/573

VB 5 | I/573
R 24000

VB 6 | I/573
R 15500

VB 7 | I/573
R 12000

VB 8 | I/573
R 18000